

GROUND FLOOR PLAN

NOTE: FLOOR PLANS BASED ON BUILDING AND TOPOGRAPHICAL SURVEY SHOWN ON RICHARD POLAK CHARTERED ARCHITECTS DRAWING CPMR3338 EX01 DATED OCTOBER 2015.

ALL ALTERATIONS TO APPROVED PLANNING AND LISTED BUILDING CONSENT DRAWINGS (INCLUDING INTERNAL LAYOUT AMENDMENTS) SUBJECT TO SEPARATE PLANNING AMENDMENT APPLICATION YET TO BE DETERMINED.

ALL STATED DIMENSIONS TO OR FROM EXISTING STRUCTURE (BY WALLS) ARE APPROXIMATE ONLY AND ARE TO BE CHECKED ON SITE PRIOR TO CONSTRUCTION WITH ANY DISCREPANCIES REPORTED TO THE ARCHITECT.

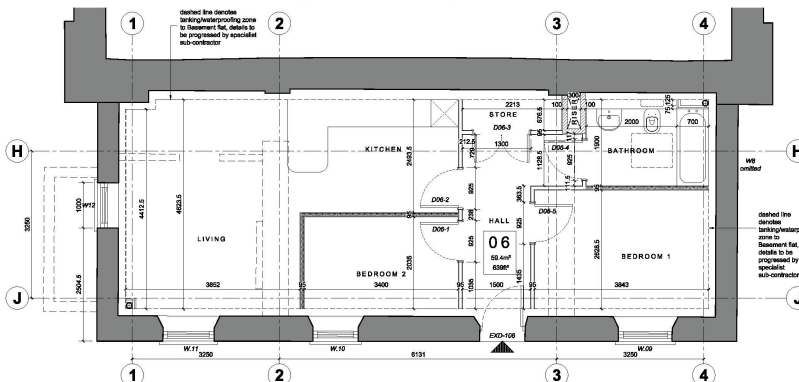

BASEMENT FLOOR PLAN

04/08/17 SVF added to kitchen, SVF added to kitchen
 23/06/17 General updates for GA issue.
 15/03/17 Basement floor plan added.
 Date: 15/03/17
 Drawn: [Name]
 Checked: [Name]

PRELIMINARY

Project Title
Wesleyan Chapel
 Blackhorse Road, Kingswood

Drawing Title
Basement & Ground Floor Plan
 As Proposed

Date
Feb 2017

Drawn
AT

Checked
AT

Scale
1:50 @A1

Project No.
2528

Drawing No.
102

Rev.
C

Cedar Yard, 200A Gloucester Road, Bristol, BS7 8PD
 T 0117 942 82 86 E architectures@angusmEEK.co.uk

Not to be reproduced in part or whole, without consent. Any discrepancies to be reported to the architect. Contractors to verify all dimensions and show on site.