



**BUILD
COMPLETION
SUMMER 2017**



Apartment 1, 1a Vernon Terrace

Lower Bristol Road, BATH. BA2 3DA

Guide Price £249,950

A newly built, two bedroom garden apartment (by prestigious local developers Crossman Homes). Situated in an exclusive development, of only four properties, in a popular location within a miles' level walk of central Bath.

Weekdays: 01225 325857

Evenings and Weekends: 01225 326420

New Apartments, Vernon Terrace, Bath. BA2 3DA

Description

A brand new development of only four, one and two bedroomed individually designed apartments by prestigious local developers Crossman Homes. Situated in this popular location within a miles' level walk of the city centre and backing onto Linear Park.

Location

Vernon Park is situated on the Lower Bristol Road at the base of the southern slopes of Bath, a historic city with two universities and world renowned for its Georgian architecture. The M4 can be reached at Junction 18 (10 miles north of the city) and provides excellent road links to London, Bristol, South Wales and the Midlands. Regular intercity rail services from Bath means that Bristol can be reached in less than 20 minutes & London Paddington in less than one and a half hours. Bristol International Airport is just 20 miles away. Less than a mile from the City Centre and railway station, Vernon terrace is between Moorland Road and Twerton High Street both offering a variety of shopping facilities. Oldfield Park has its own railway station providing local services to Bath and Bristol. There is a choice of doctors' surgeries in the area, a dental practice and a choice of local schools.

Directions

From Queen Square follow the road from the bottom left corner towards Green Park. Filter right over the Midland Bridge, following the road straight on at the traffic lights, turning left on to the Lower Bristol Road. Follow The Lower Bristol Road through two sets of traffic lights, passing the Windsor Bridge on the right Hand side. Vernon Terrace will be found on the left hand side. The site will be found on the left on the corner of Bellotts Road.

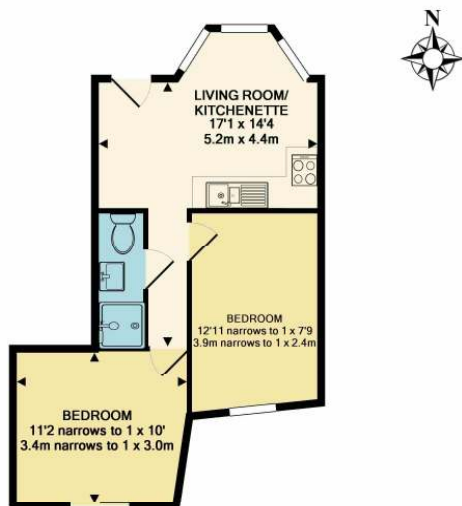

APT 1, 1A VERNON TERRACE, LOWER BRISTOL ROAD, BATH
TOTAL APPROX. FLOOR AREA 406 SQ.FT. (37.7 SQ.M.)

Whilst every attempt has been made to ensure the accuracy of the floor plan contained here, measurements of doors, windows, rooms and any other items are approximate and no responsibility is taken for any error, omission, or mis-statement. This plan is for illustrative purposes only and should be used as such by any prospective purchaser. The services, systems and appliances shown have not been tested and no guarantee

Regency House, 2 Wood Street, Bath BA1 2JQ T: 01225 325857

E: tim@timbennettandassociates.co.uk W: www.timbennettandassociates.co.uk